

客户会签

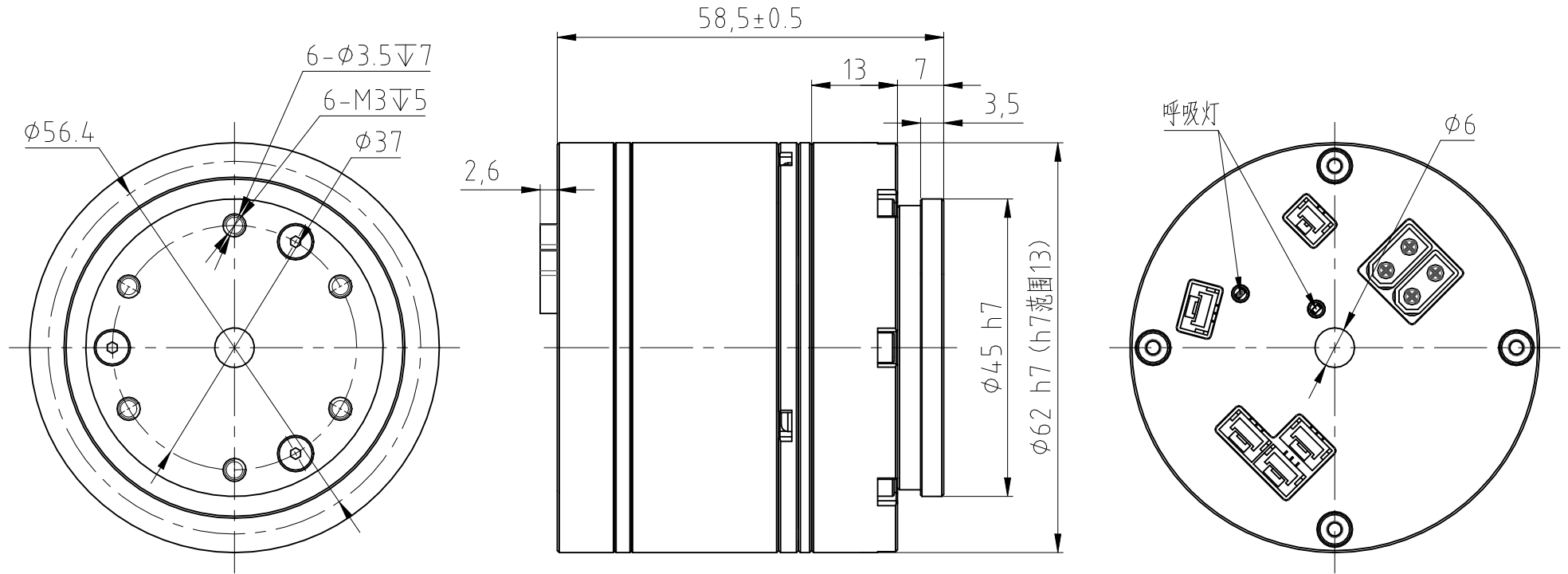

					Rotary Actuator			L62I-C-XXX-BF-C00	
标记	处数	更改内容	签字	日期	客户图样标记	重量(kg)	比例	<b>Laitual Drive</b> 浙江来福谐波传动股份有限公司	
设计							1:1		
审核									
批准									
工艺会签									
		版本号		A1	共 2 页		第 1 页		

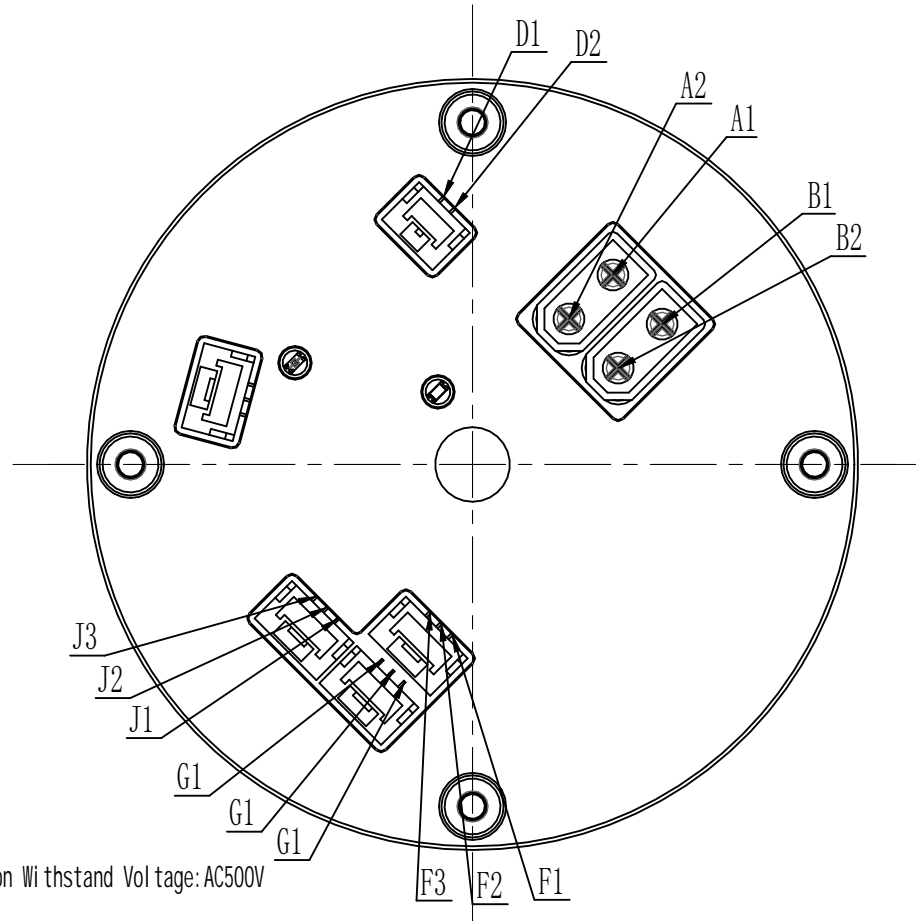

Technical Requirements:

1. Insulation Resistance(DC500V)>500M ; Insulation Withstand Voltage: AC500V (1minute), Less than 5mA ;
2. Motor-side Encoder Resolution: 16-bit multi-turn, 17-bit single-turn ; Reducer-side Encoder Resolution: 17-bit single-turn(Optional, not configured by default for standard products) ;
3. Bus Protocol: Canopen;
4. Appearance: No visible burrs, scratches, bumps or other defects ;
5. Storage temperature for standard products: -20~80, Operating temperature: -10~55 ; Storage temperature for special products: -40~80, Operating temperature: -30~55 ;
6. Unidirectional positioning accuracy: 60 Arcsec, Repetitive positioning accuracy: 20Arcsec.

Module Signal Definition		
Pin No.	Signal Name	Remarks
A1/B1	VBUS+	Bus Power Input/Output Positive
A2/B2	VBUS-	Bus Power Input/Output Negative
D1	BAT+	Multi-turn Encoder Backup Battery Positive
D2	BAT-	Multi-turn Encoder Backup Battery Negative
F1/G1	CAN_H	CAN Bus High Signal
F2/G2	CAN_GND	CAN Bus Ground
F3/G3	CAN_L	CAN Bus Low Signal
J1/K1	RS485_A	RS485 Bus A Terminal
J2/K2	RS485_GND	RS485 Bus Ground
J3/K3	RS485_B	RS485 Bus B Terminal

Module Data											Rotary Actuator				L62I-C-XXX-BF-C00					
Ratio	Ratio Torque (Nm)	Permissible peak torque at start /stop(Nm)	Instantaneous permissible max torque(Nm)	Rated Speed (rpm)	Max. Speed (rpm)	Rated Current (A)	Max. Current (A)	Tg·Constant (Nm/Arms)	Inertia Moment (kg·mm²)	Weight (kg)	标记	处数	更改内容	签字	日期	客户图样标记	重量(kg)	比例		
51	5.5	8.3	17	98	117.6	2.44	3.68	2.25	15.5	0.63	设计				GJ-DW-ME-0055		1:1	<b>Laitual Drive</b> 浙江来福谐波传动股份有限公司		
—	—	—	—	—	—	—	—	—			审核									
101	8.9	11	25	49.5	59.4	1.99	2.46	4.47			批准									
—	—	—	—	—	—	—	—	—			工艺会签									
													版本号	A1	共 2 页		第 2 页			